

PISO L (TÉRREO)

GROUND FLOOR



| | Área Area | Dimensões Dimensions | Altura Height | Auditório Auditorium | Escola School | Sala em "U" "U" Shape | Banquete Banquet | Coquetel Cocktail | Esp. Peixe Fish |
|------------------------------------|-----------------------|-------------------------|------------------|-------------------------|------------------|--------------------------|---------------------|----------------------|--------------------|
| Foyer r Spazio | 49,00 m ² | 7,00 x 7,00 | 2,73 - 2,95 | — | — | — | — | — | — |
| Áurea | 63,36 m ² | 8,80 x 7,20 | 2,73 - 2,95 | 50 | 24 | 20 | 30 | 50 | 24 |
| Magna | 62,48 m ² | 8,80 x 7,10 | 2,73 - 2,95 | 50 | 24 | 20 | 30 | 50 | 24 |
| Argentea | 62,30 m ² | 8,80 x 7,08 | 2,73 - 2,95 | 50 | 24 | 20 | 30 | 50 | 24 |
| Senatus | 82,47 m ² | 9,68 x 8,52 | 2,73 - 2,95 | 70 | 40 | 25 | 30 | 80 | 25 |
| Aventino | 271,87 m ² | 15,13 x 14,40 | 2,73 - 2,95 | 220 | 80 | 50 | 120 | 250 | 80 |
| Caelius | 255,70 m ² | 16,90 x 15,13 | 2,73 - 2,95 | 280 | 100 | 60 | 140 | 300 | 60 |
| Áurea + Magna | 125,84 m ² | 58,10 x 53,12 | 2,73 - 2,95 | 120 | 40 | 30 | 60 | 100 | 40 |
| Magna + Argentea | 124,78 m ² | 53,12 x 49,80 | 2,73 - 2,95 | 120 | 40 | 30 | 60 | 100 | 40 |
| Senatus + Argentea | 144,77 m ² | 72,21 x 49,80 | 2,73 - 2,95 | 140 | 70 | 40 | 80 | 150 | 50 |
| Áurea + Magna + Argentea | 188,14 m ² | 111,22 x 49,80 | 2,73 - 2,95 | 180 | 80 | 60 | 100 | 220 | 60 |
| Áurea + Magna + Argentea + Senatus | 213,61 m ² | 111,22 x 122,01 | 2,73 - 2,95 | 250 | 120 | 90 | 150 | 300 | 100 |
| Aventino + Caelius | 473,57 m ² | 180,88 x 213,52 | 2,73 - 2,95 | 550 | 270 | 100 | 250 | 500 | 270 |
| * Spazio | 855,79 m ² | 30,95 x 24,00 | 2,73 - 2,95 | 1000 | 300 | — | 500 | 1000 | 300 |

*J unição de todos os salões. / *All meeting rooms together.

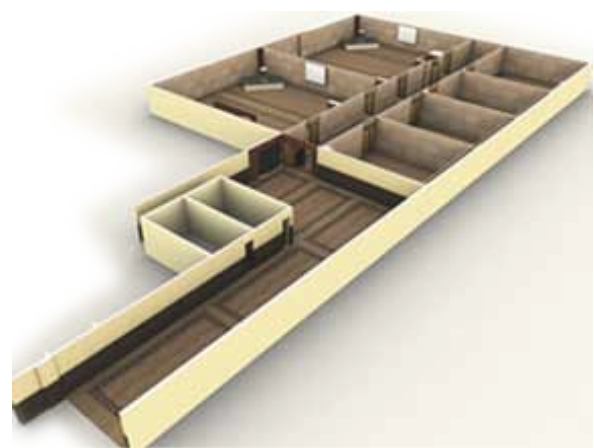

BUSINESS CENTER (PISO L)

| | Capacidade Seating |
|-----------------|-----------------------|
| Sala 1 / Room 1 | 12 pessoas / people |
| Sala 2 / Room 2 | 10 pessoas / people |



BUSINESS 1

PISO E LEVEL E



CAPITÓLIO

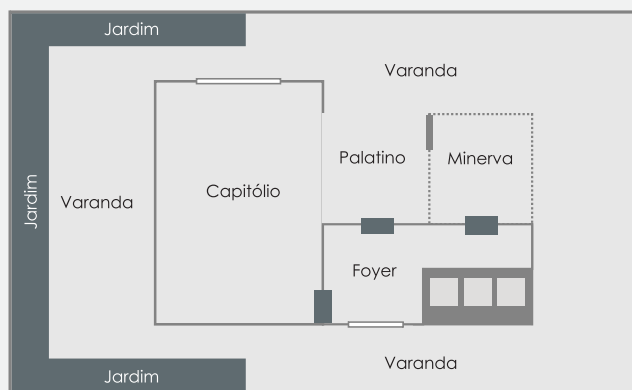

| | Área Area | Dimensões Dimensions | Altura Height | Audatório Auditorium | Escola School | Sala em "U" "U" Shape | Banquete Banquet | Coquetel Cocktail | Esp. Peixe Fish |
|-----------|-----------------------|-------------------------|------------------|-------------------------|------------------|--------------------------|---------------------|----------------------|--------------------|
| Capitório | 153,97 m ² | 17,80 x 8,65 | 2,45 - 3,18 | | | | | | |
| Palatino | 45,53 m ² | 6,17 x 7,38 | 2,60 | 30 | 20 | 18 | 20 | 30 | 20 |
| Minerva | 51,40 m ² | 7,10 x 7,24 | 2,60 | 30 | 20 | 18 | 20 | 30 | 20 |
| Foyer | 43,38 m ² | 6,18 x 7,02 | 3,80 | — | — | — | — | — | — |

PISO R (PORTOFINO)
 LEVEL R (PORTOFINO)

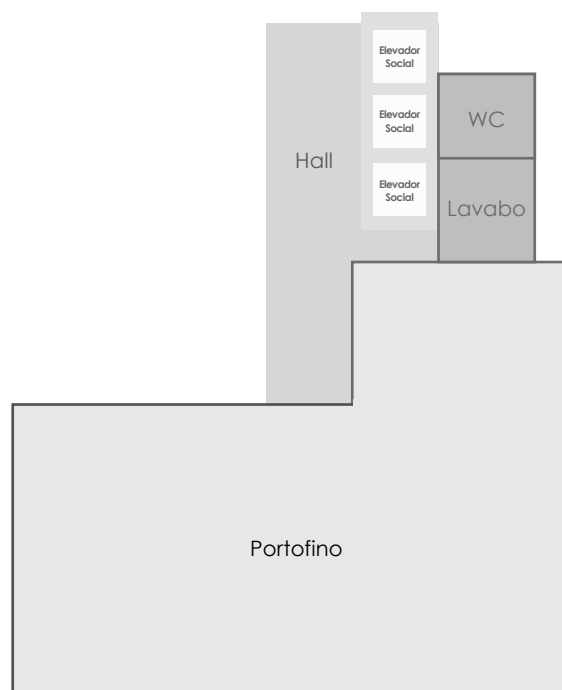

* Salão com vista para o mar
 * Meeting room with ocean view

| | Área Area | Dimensões Dimensions | Altura Height | Auditório Auditorium | Escola School | Sala em "U" "U" Shape | Banquete Banquet | Coquetel Cocktail | Esp. Peixe Fish |
|-----------|--------------------|-------------------------|------------------|-------------------------|------------------|--------------------------|---------------------|----------------------|--------------------|
| Portofino | 265 m ² | 20m x 8,87m | 2,40 | 120 | 60 | 40 | 130 | 200 | 60 |



PORTOFINO

COBERTURA
PENTHOUSE



| | Área Area | Dimensões Dimensions | Altura Height | Auditório Auditorium | Escola School | Sala em "U" "U" Shape | Banquete Banquet | Coquetel Cocktail | Esp. Peixe Fish |
|-------------|-----------------------|-------------------------|------------------|-------------------------|------------------|--------------------------|---------------------|----------------------|--------------------|
| | | | | | | | | | |
| Star | 69,92 m ² | 9,20 x 7,60 | 2,37 - 2,80 | 50 | 24 | 20 | 30 | 50 | 24 |
| Moon | 65,32 m ² | 9,20 x 7,60 | 2,37 - 2,80 | 50 | 24 | 20 | 30 | 50 | 24 |
| Orion | 60,72 m ² | 9,20 x 7,10 | 2,37 - 2,80 | 50 | 24 | 20 | 30 | 50 | 24 |
| Sky | 114,72 m ² | 9,20 x 6,60 | 2,37 - 2,80 | 90 | 40 | 30 | 50 | 100 | 40 |
| *Blue Night | 343,68 m ² | 12,00 x 28,64 | 2,37 - 2,80 | 250 | 80 | 60 | 200 | 300 | 70 |

*Junção de todos os salões. / *All meeting rooms together.

